

FOR LEASE

35 Jim Kimmett Blvd, Unit #2

Napanee, ON

1,851 SF | OFFICE/RETAIL



PRIME LOCATION PLAZA JUST OFF THE 401

PROPERTY FEATURES

- Excellent location in high traffic area
- Electronic pylon sign
- Signage visibility from Highway 401
- High traffic corner and plaza
- Space may be combined with Unit 3 for a total of 2,941 sf

Lease Rate:	\$20.00 PSF Net*
Additional Rent:	\$10.44 PSF (2022)
Available Area:	1,851 SF
Zoning:	C2
Water/Sewer:	Municipal
Utilities:	Tenant expense
Parking:	Ample parking on site

*Space to be provided on a vanilla finish

Providing Solutions

Kostas Doulas
Broker of Record
613-384-1997 ext. 17
kdoulas@rtcr.com

Stephen Gray
Sales Representative
613-384-1997 ext. 19
sgray@rtcr.com

20 Gore Street, Suite 102
Kingston, Ontario
K7L 2L1
www.rtcr.com

**Rogers
& Trainor**

Commercial Realty Inc.
Brokerage

All information provided is deemed reliable but is not guaranteed and should be independently verified.

FOR LEASE

35 Jim Kimmett Blvd, Unit #2

Napanee, ON

1,851 SF | OFFICE/RETAIL

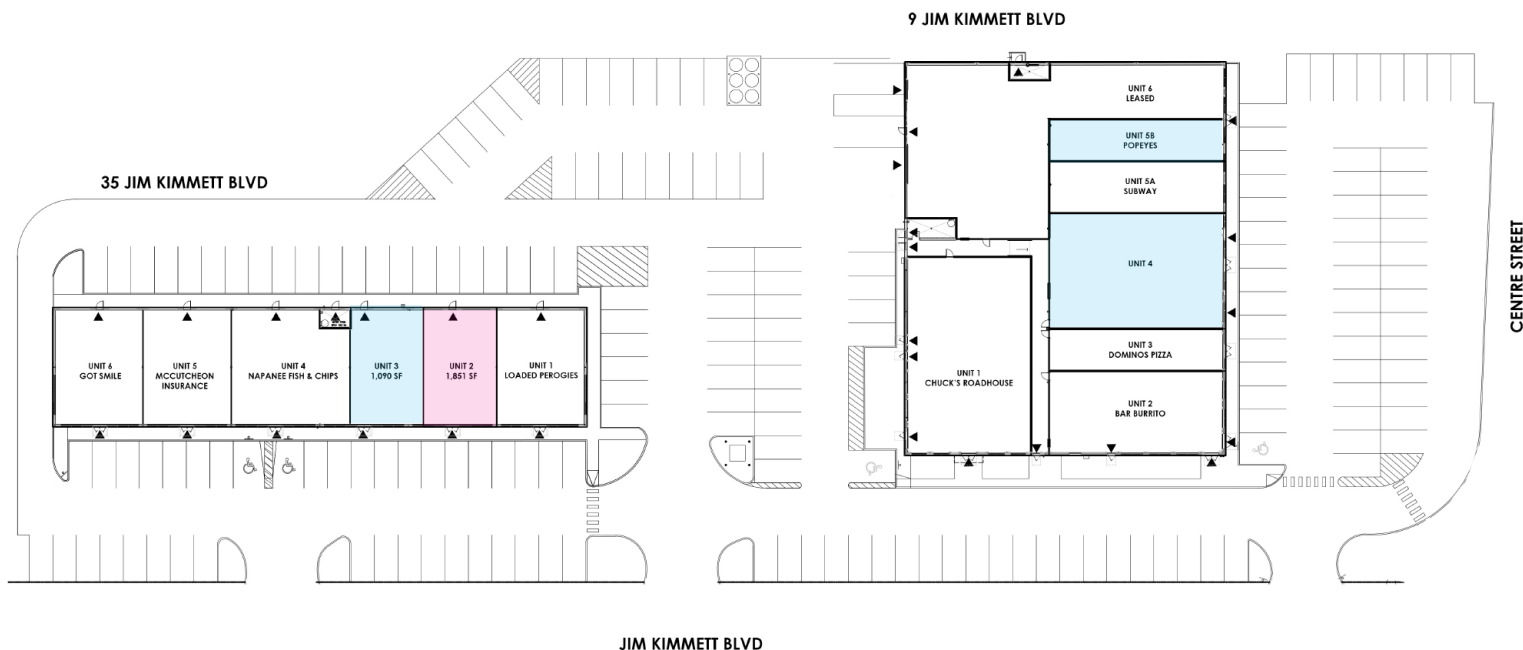

35 JIM KIMMETT BLVD. - UNIT 2 (1,851 SF)

ALSO AVAILABLE:

35 JIM KIMMETT BLVD. - UNIT 2 (1,090 SF)

9 JIM KIMMETT BLVD. - UNIT 5B (2,186 SF), UNIT 4 (3600 SF)

