

FOR LEASE

OFFICE/LIGHT INDUSTRIAL SPACE



720 PROGRESS AVENUE, UNITS 3 & 4

LEASEABLE AREA:	+/-1,965 SF
LEASE RATE:	\$12.00 PSF (2023)
ADDITIONAL RENT:	\$4.00 PSF (2023 est.)
ZONING:	M2-26
UTILITIES:	To be paid by Tenant
PARKING:	Ample Parking on site
SIGNAGE	On facia & pylon sign on Progress Ave.

SPACE

- 1,965 sf of office/light industrial space
- No dock or door
- Two (2) barrier free washrooms on site
- Existing improvements may be economically reused with cost savings

LOCATION

- Located just 650m from the RioCan Centre
- Access to property includes a signalized, lighted intersection and a local transit stop.
- High visibility and signage

Rogers & Trainor
Commercial Realty Inc.
Brokerage

20 Gore Street, Suite 102
Kingston, Ontario K7L 2L1
613-384-1997
www.rtrc.com

STEPHEN GRAY
Sales Representative

✉ sgray@rtrc.com
☎ 613-572-1544
☎ 613-384-1997 ext. 19

All information provided is deemed reliable but is not guaranteed and should be independently verified.

FOR LEASE

720 PROGRESS AVENUE, UNITS 3 & 4



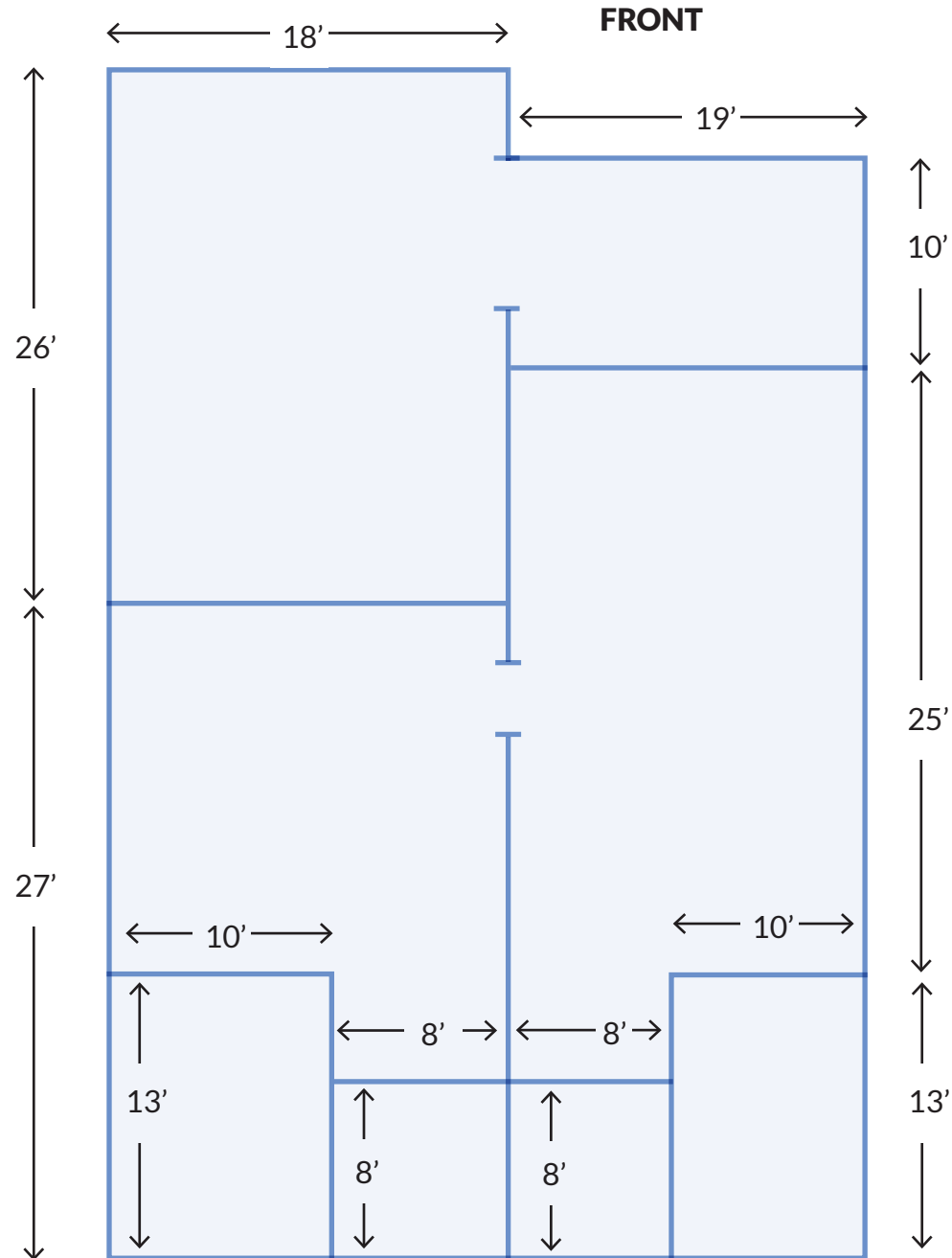

*** For Illustrative purposes only**



FOR LEASE

720 PROGRESS AVENUE KINGSTON

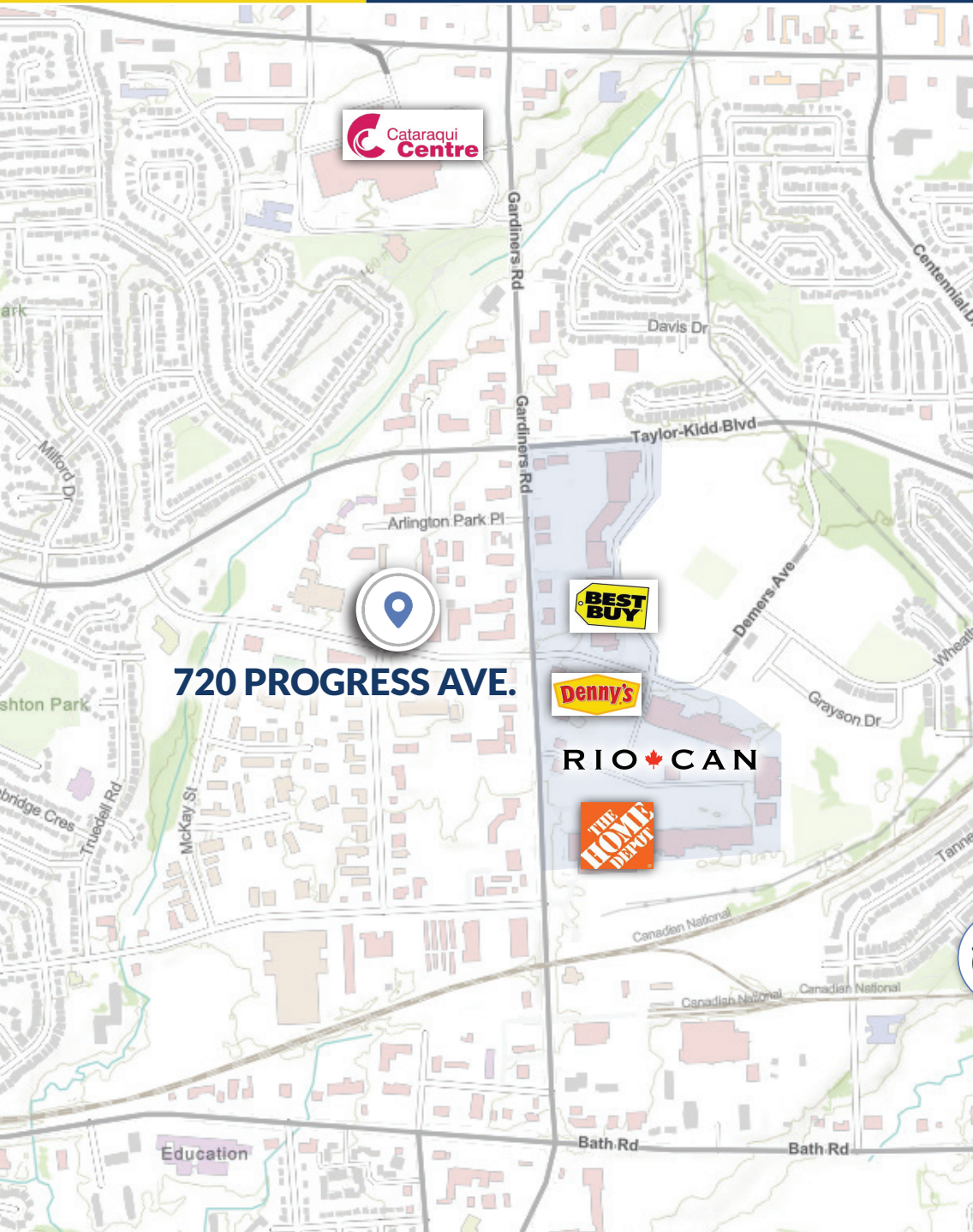

NEIGHBOURHOOD HIGHLIGHTS

RIO CAN

- The Brick
- Home Depot
- Best Buy
- JYSK
- Scotiabank
- PetSmart
- Dollarama
- East Side Mario's
- Kelsey's
- Staples

- Lee Valley
- Mark's
- Urban Barn
- Cineplex
- Giant Tiger
- Home Outfitters
- Jolie Home Decor
- Denny's
- Montana's
- Golf Town

LOCAL BUSINESS

- CarOne
- Sleep Country
- Boston Pizza
- Ardens Music
- Chumleighs
- Habitat for Humanity
- Speedy
- Saigon Delights
- Red Swan Pizza
- Luxe Nails

RIO CAN

650 M FROM
720 PROGRESS AVE.



- 63 units with over 750,000 sf of retail space
- Plaza anchors include Cineplex Odeon, Home Depot, The Brick, Home Outfitters, Winners, and HomeSense
- Heavy traffic area, easily accessible by public transit
- Excellent mix of national retailers



TRAFFIC COUNTS

City of Kingston 2017
TAYLOR KIDD BLVD AT GARDINERS RD

27,326 NORTH BOUND TRAFFIC

28,138 SOUTH BOUND TRAFFIC

22,754 EAST BOUND TRAFFIC

19,490 WEST BOUND TRAFFIC